

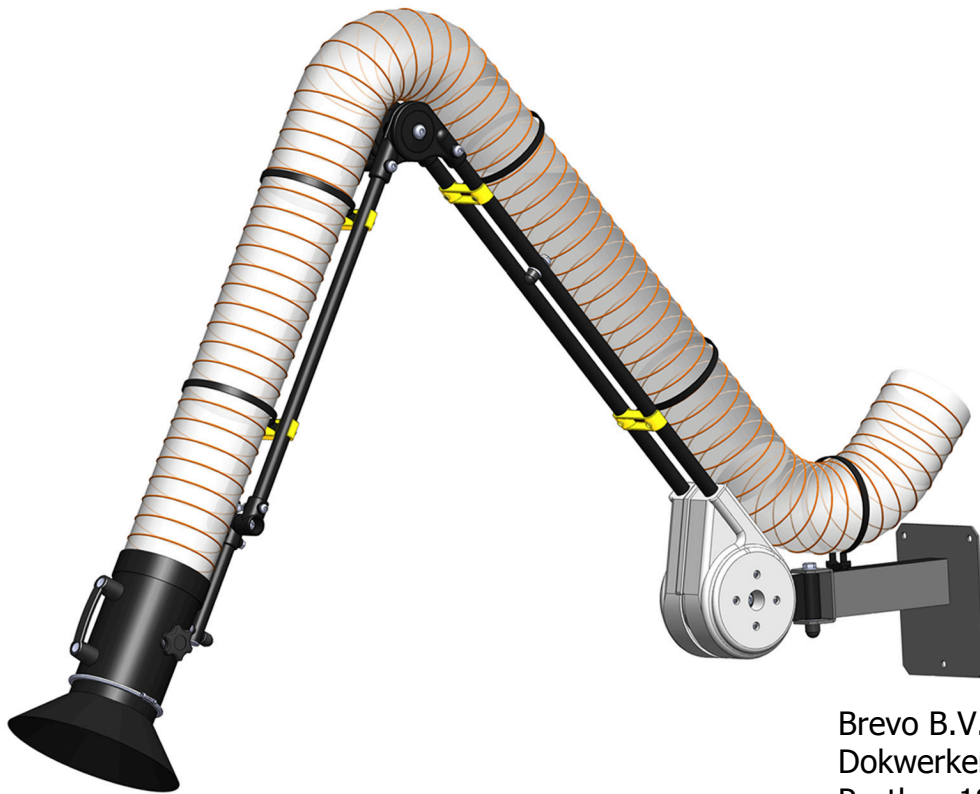

Articulated HPD

Hood Positioning Device



Brevo B.V.
Dokwerkerstraat 3, 2984 BJ
Postbus 184, 2980 AD
Ridderkerk
T : 0180-417344
F : 0180-411563
E : info@brevo.nl
W : www.flextraction.nl

Manual

Read this manual carefully before installation and operation

Contents

Mounting Bracket Installation	2
HPD Installation	5
Maintenance	7
Adjustment	8
Spare parts and accessories	9

Mounting Bracket Installation

For ease of installation all flextraction Hood Positioning Devices (HPDs) are supplied fully assembled* and complete with mounting plate. Please refer to the correct section below to mount the supplied bracket system.

(*Unless supplied without the standard wall mounting bracket)

Ensure that any mounting surface is sufficient to bear the load of any articulated HPD.

Installation of the articulated HPD

1a) *Installation of the wall/post mounting bracket;*

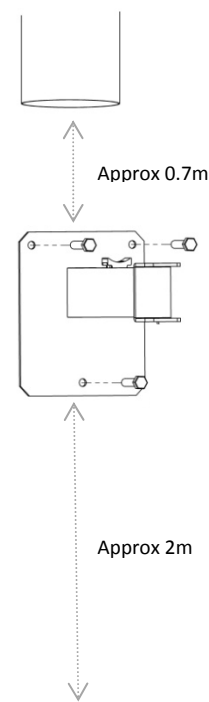

The recommended position of the wall/post mounting bracket is 2m from level ground and 0.7m from the duct connection.

1b) Installation of the ceiling mounting bracket (if supplied);

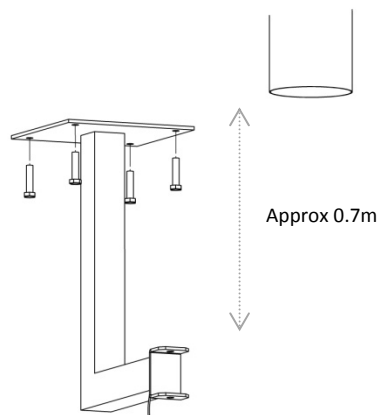

It is recommended that the ceiling bracket is installed within 0.7m of the duct connection.

1c) Installation of the boom extension system (1m/2m/3m - if supplied);

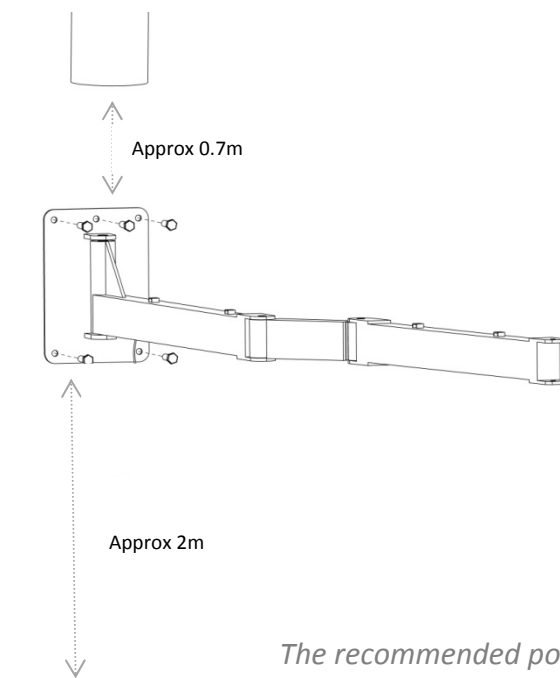

The recommended position of the boom extension is approximately 2m from level ground and approximately 0.7m from the duct connection.

1d) Installation of the boom extension system (4m/5m - if supplied);

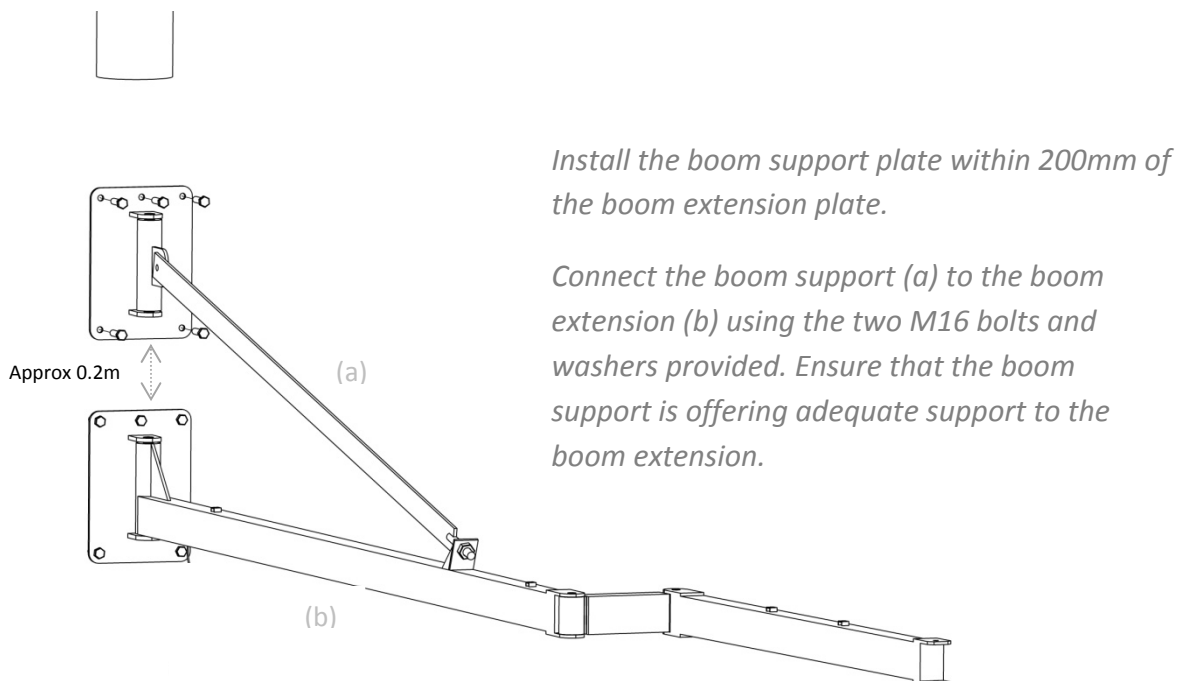
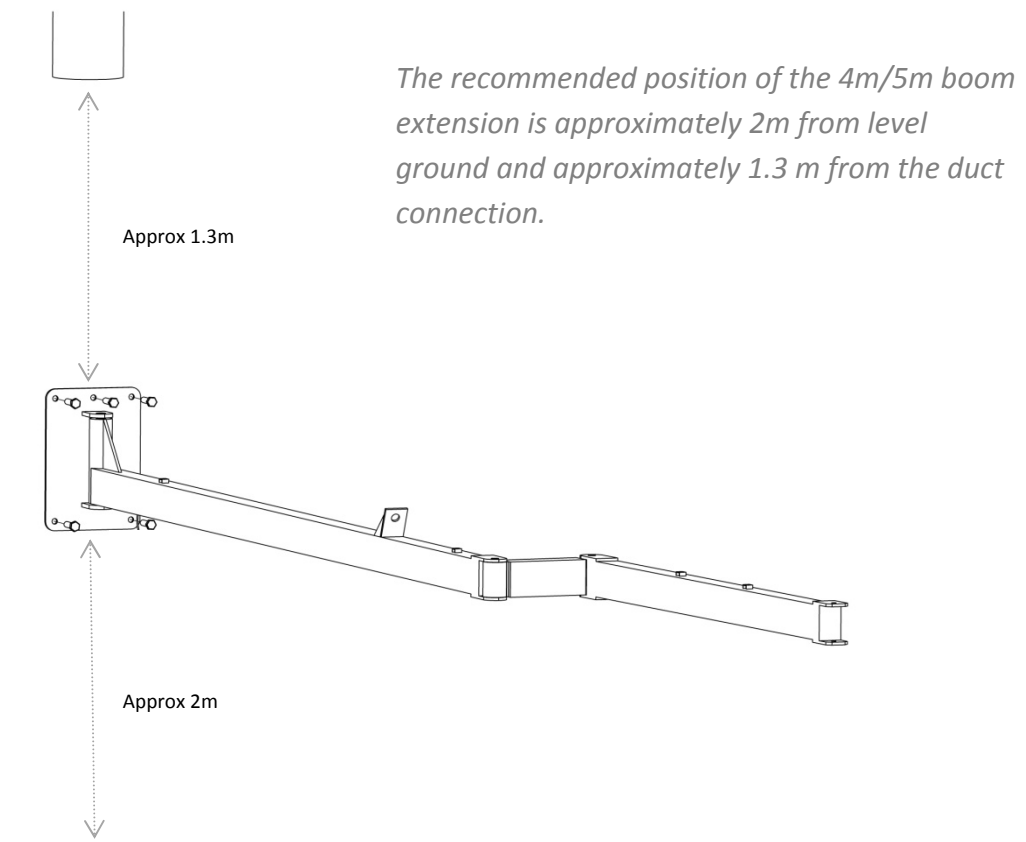

2) Mounting the HPD

Once the bracket has been securely attached the HPD can be mounted to the bracket using the fixings provided.

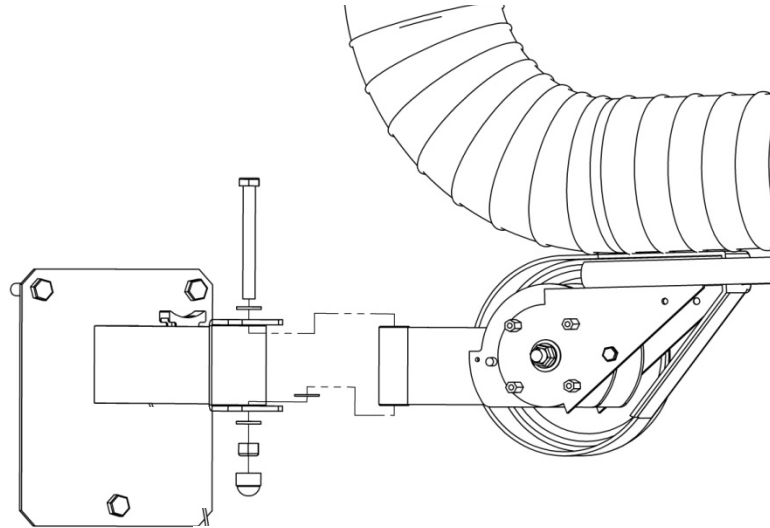

3) Removal of the locking pin

The articulated range of HPDs is fitted with a temporary locking pin to aid with the installation. **THE LOCKING PIN MUST BE REMOVED ONCE THE HPD HAS BEEN FITTED TO ITS MOUNTING BRACKET AND BEFORE ANY ATTEMPT IS MADE TO MANOEUVRE IT INTO POSITION.**

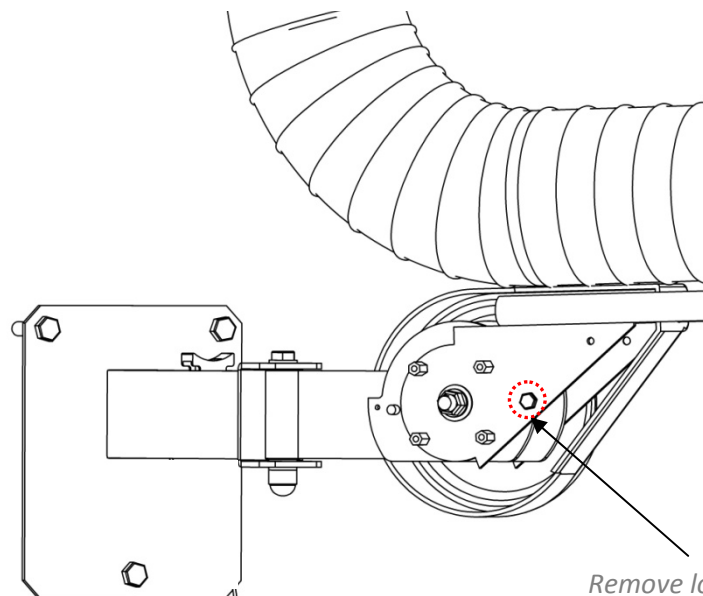

Remove locking pin bolt before attempting to position the articulated HPD into position.

Once the locking pin has been removed the rear casing can be attached into position using the four button head bolts provided.

4) Fixing the hose

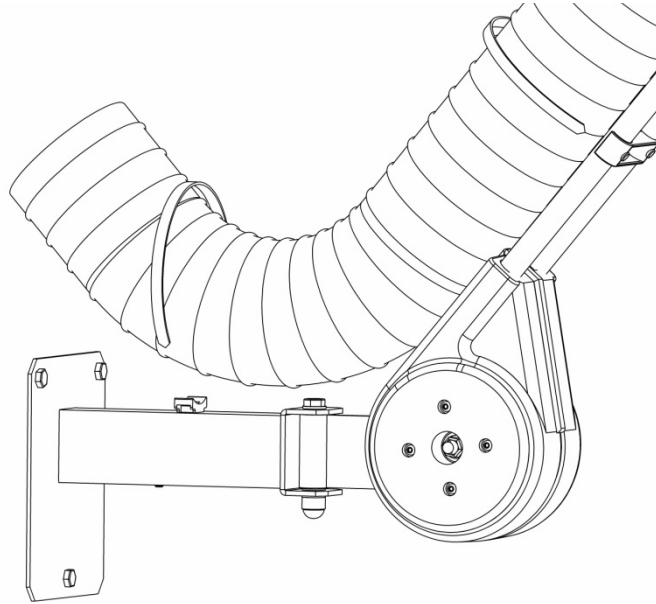

Use the hose strap provided to fix the hose to the mounting bracket, allow enough hose to ensure free movement of the HPD.

If the HPD has been installed using a boom extension use the hose straps provided to secure the hose ensuring the boom is free to pivot.

5) Installation check

- Ensure that all bolts have been securely fastened.
- Ensure the **TEMPORARY LOCKING PIN BOLT** has been removed and the case is securely fixed into position.
- Check that the flexible hose is securely connected to the duct outlet.
- Check that the HPD holds a fixed position, if adjustment is required please refer to page 9 of this manual.

Maintenance

Ensure that any persons cleaning the equipment are wearing adequate (PPE) personal protection equipment.

Periodic cleaning of the HPD is recommended using warm water and a mild detergent to remove any excess dust or dirt build up.

DO NOT USE AGGRESSIVE CLEANING AGENTS ON THE EQUIPMENT AS THIS MAY LEAD TO DAMAGE TO THE HPD AND HOSE.

Adjustment

The equipment is fitted with easily accessible externally mounted fixings to simplify the adjustment of any joint. It is normal practice for friction joints to become slack under use and periodic adjustment maybe necessary for the equipment to maintain a self supporting position.

WARNING: The articulated HPD is fitted with tension springs that allow the product to self support. These springs are under constant tension and no attempt should be made to interfere with the spring or its mechanisms – If you have any questions or queries or are in any doubt contact flextraction Ltd.

To adjust the HPD the following tools will be required;

- 6mm & 8mm Hex key
- Socket ratchet
- 17mm & 19mm Socket
- 17mm & 19mm Spanner

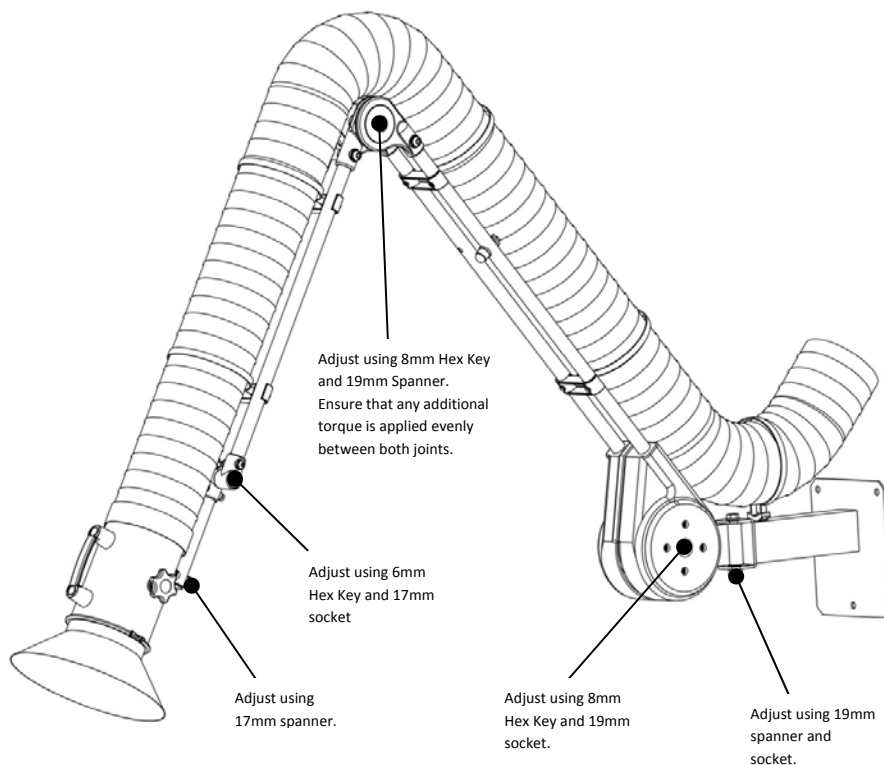

Spare parts and accessories

Spares parts and accessories can be ordered directly from flextraction Ltd. When ordering spare parts quote the serial number, part name, part number and quantity. The serial number can be located on the rear pivot joint of the HPD.

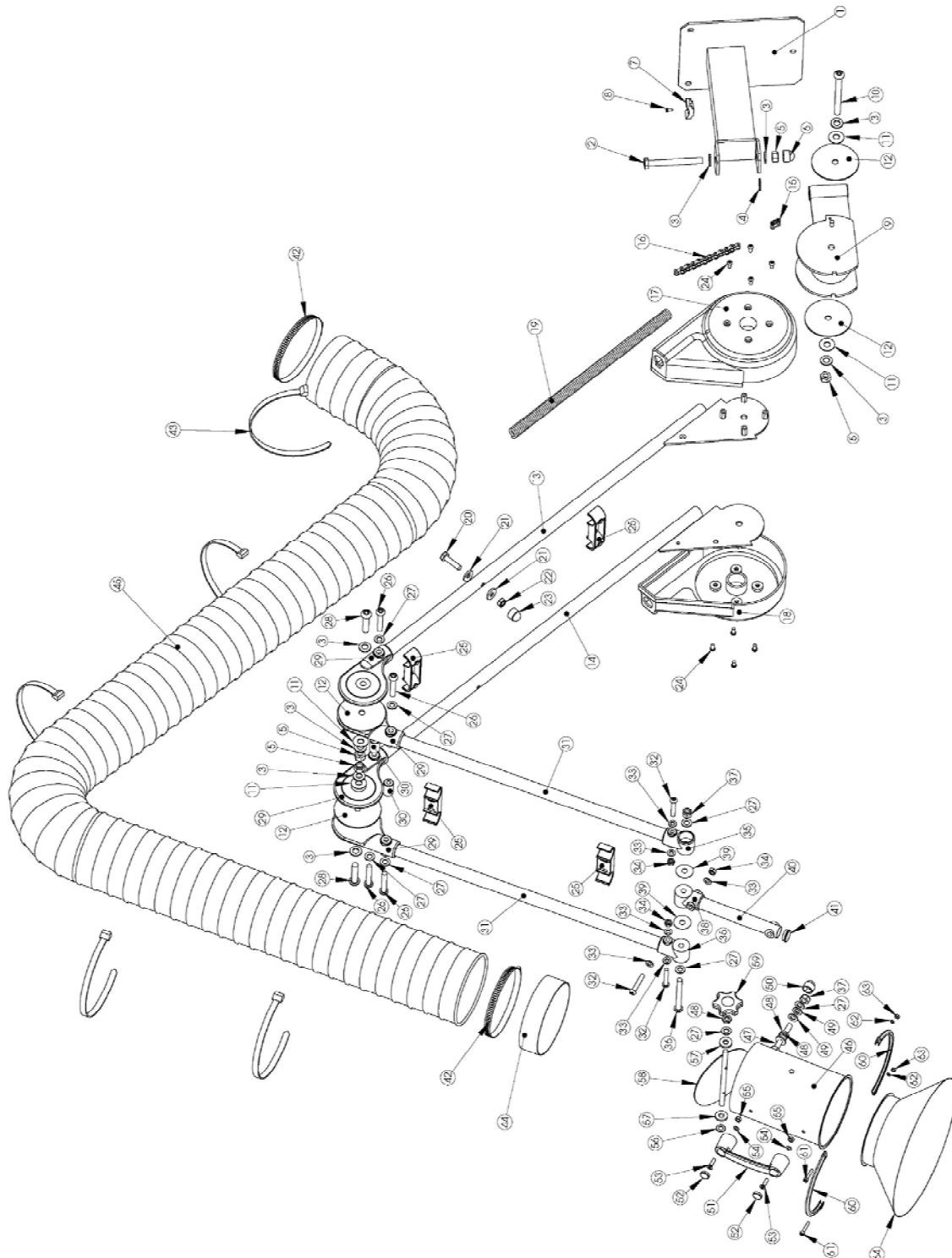

Articulated HPD

No.	Part		
1	Wall plate	33	Washer
2	Bolt	34	Nut
3	Washer	35	End Casting
4	Friction washer	36	Bolt
5	Nut	37	Nut
6	Nut cap	38	Centre Casting
7	Cable tie anchor	39	Washer
8	Screw	40	Front tube
9	Rear friction joint	41	Tube insert
10	Bolt	42	Hose clamp
11	Beville washer	43	Hose strap
12	Friction pad	44	Hose clamp band
13	Left rear support	45	Hose
14	Right rear support	46	Nozzle body
15	Chain connector	47	Bolt
16	Chain	48	Half nut
17	Casing left	49	Washer
18	Casing right	50	Nut cap
19	Tension spring	51	Handle
20	Bolt	52	Handle caps
21	Saddle washer	53	Bolt
22	Nut	54	Washer
23	Nut cap	55	Nut
24	Bolt	56	Star cap
25	Centre clip	57	Washer
26	Bolt	58	Damper
27	Washer	59	Wheel handle
28	Bolt	60	Split ring
29	Centre Casting	61	Bolt
30	Bush	62	Washer
31	Centre Tube	63	Nut
32	Bolt	64	Hood



Brevo B.V.
Dokwerkerstraat 3, 2984 BJ
Postbus 184, 2980 AD
Ridderkerk
T : 0180-417344
F : 0180-411563
E : info@brevo.nl
W : www.flextraction.nl